

LESTER P.U.D. PLAT SIX

BEING A REPLAT OF TRACTS "I", "K", "M", "N", "R" AND LOTS 38, 44 AND 45 OF LESTER P.U.D. - PLAT FOUR, AS RECORDED IN PLAT BOOK 88, PAGES 126-131, PUBLIC RECORDS OF PALM BEACH COUNTY, FLORIDA, AND TRACTS "G", "J" AND LOTS 49 AND 108 OF LESTER P.U.D. - PLAT FIVE, AS RECORDED IN PLAT BOOK 88, PAGES 78-83, PUBLIC RECORDS OF PALM BEACH COUNTY, FLORIDA, AND A PORTION OF THE SOUTHEAST ONE-QUARTER (SE 1/4) OF SECTION 35, TOWNSHIP 45 SOUTH, RANGE 42 EAST, PALM BEACH COUNTY, FLORIDA.

106

STATE OF FLORIDA } S.S.
COUNTY OF PALM BEACH }
THIS PLAT WAS FILED FOR
RECORD AT _____ DAY OF
THIS _____, AD. 20____ AND
DULY RECORDED IN PLAT BOOK
_____, ON PAGES _____ AND

DOROTHY H. WILKEN, CLERK
CIRCUIT COURT
BY: _____ DC

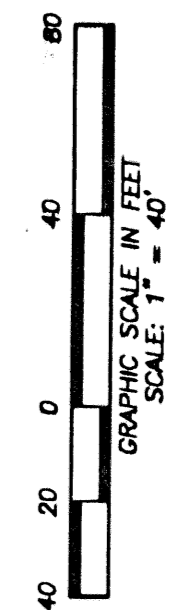

- LEGEND:
- (C) = CALCULATED
 - CMB = COMMISSIONERS' MINUTES BOOK
 - DE = DRAINAGE EASEMENT
 - DB = DEED BOOK
 - FND = FOUND
 - FPL = FLORIDA POWER & LIGHT
 - IP = IRON PIPE
 - IRC = IRON ROD WITH PLASTIC CAP
 - LAE = LIMITED ACCESS EASEMENT
 - LB = LICENSE BUSINESS
 - LBE = LANDSCAPE BUFFER EASEMENT
 - LME = LAKE MAINTENANCE EASEMENT
 - LMAE = LAKE MAINTENANCE ACCESS EASEMENT
 - LS = LICENSE SURVEYOR
 - LWDD = LAKE WORTH DRAINAGE DISTRICT
 - (M) = MEASURED
 - MON = MONUMENT
 - ORB = OFFICIAL RECORD BOOK
 - (P) = PLAT
 - PB = PLAT BOOK
 - PG = PAGE(S)
 - POB = POINT OF BEGINNING
 - POC = POINT OF COMMENCEMENT
 - PRM = PERMANENT REFERENCE MONUMENT
 - RR = RADIAL TO REAR LOT LINE
 - RF = RADIAL TO FRONT LOT LINE
 - R/W = RIGHT-OF-WAY
 - RPB = ROAD PLAT BOOK
 - (S) = SURVEY
 - UE = UTILITY EASEMENT
 - ZLME = ZERO LOT LINE MAINTENANCE EASEMENT
 - (*) = SET PERMANENT CONTROL POINT (PCP) "LB#7055"
 - = SET 4"x4" CONCRETE MONUMENT "LB#7055" UNLESS OTHERWISE SHOWN

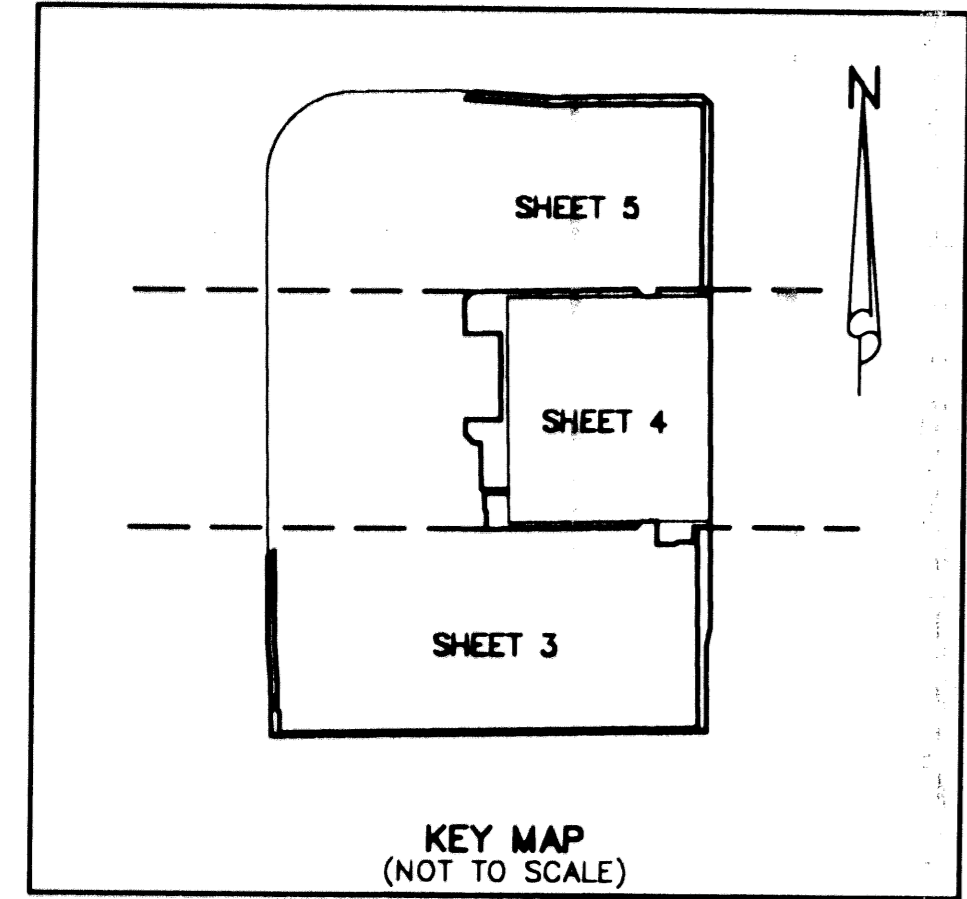

MAY, 2001 SHEET 4 OF 5

LESTER P.U.D. - PLAT FOUR
(PB 88, PG 126-131)

LESTER P.U.D. - PLAT FIVE
(PB 88, PG 78-83)

LESTER PUD Plat 6
DATE: 10/20/00
DRAWN BY: [Name]
CHECKED BY: [Name]
APP. BY: [Name]
ZEP CODE: 33437
PROJECT NO: 454

CAD	K:\LEVIT\LESTER\DWG\LESTPLT6	DWG	00-022
REF	K:\LEVIT\LESTER\DWG\LESTM601	DATE	12/20/00
FLD	RP/AB	JOB	00-031B
OFF	A-JP	DATE	12/20/00
CHKD	RPB	SHEET	4 OF 5

Wantman Group, Inc.
Engineering • Surveying • Mapping
901 WORTHPOINT PARKWAY, SUITE 204
WEST PALM BEACH, FLORIDA 33411
(561) 687-2220 ext. 561
CERT. NO. 6081 - LB. NO. 7055